

MIL SPEC CABLE AND FITTINGS

MIL-DTL-83420 CABLE

MIL-DTL-83420 cables are primarily used with MS-type terminals for both commercial aircraft and military applications. SAVA sells this cable in bulk or will quote your cable assembly design in compliance with MIL-T-6117 or MIL-T-781. We are fully equipped

to proof load or prestress your assemblies to reduce construction stretch and provide fitting reliability. For commercial grades of the equivalent cables at greatly reduced price, please refer to pages 8, 9, 10 and 11 of this catalog.

TYPE I NON-JACKETED WIRE ROPE

MIL-DTL-83420,
LATEST AMENDMENT
COMPOSITION B,
CORROSION RESISTANT
STEEL

SAVA Part No.	Nominal Cable Dia.		Construction	Tolerance on Diameter (Plus Only)		Allowable Increase of Dia. at Cut End		Minimum Breaking Strength Composition B		Approximate Weight per 100 Feet	
	in.	mm		in.	mm	in.	mm	lbs.	kg	lbs.	kg
S030	1/32	.79	3x7	.006	.152	.006	.152	110	50	0.16	0.07
S048	3/64	1.19	7x7	.008	.203	.008	.203	270	122	0.42	0.19
S064	1/16	1.59	7x7	.010	.254	.009	.229	480	218	0.75	0.34
S065	1/16	1.59	7x19	.010	.254	.009	.229	480	218	0.75	0.34
S094	3/32	2.38	7x7	.012	.305	.010	.254	920	418	1.60	0.72
S095	3/32	2.38	7x19	.012	.305	.010	.254	920	418	1.74	0.79
S126	1/8	3.18	7x19	.014	.356	.011	.279	1,760	798	2.90	1.31
S158	5/32	3.97	7x19	.016	.406	.017	.432	2,400	1089	4.50	2.04
S188	3/16	4.76	7x19	.018	.457	.019	.483	3,700	1678	6.50	2.95
S252	1/4	6.35	7x19	.018	.457	.021	.533	6,400	2903	11.00	4.99
S315	5/16	7.94	7x19	.022	.559	.024	.610	9,000	4082	17.30	7.85
S375	3/8	9.53	7x19	.026	.660	.027	.686	12,000	5443	24.80	11.00

TYPE II JACKETED WIRE ROPE

MIL-DTL-83420,
LATEST AMENDMENT
COMPOSITION B,
CORROSION RESISTANT
STEEL WITH
NYLON JACKET

SAVA Part No.	Nominal Cable Dia.		Construction	Outside Diameter of Jacket		Tolerance on Jacket O.D. (Plus Only)		Jacket Wall Thickness (Reference)		Approximate Weight per 100 Feet	
	in.	mm		in.	mm	in.	mm	in.	mm	lbs.	kg
S030N047	1/32	.79	3x7	3/64	1.19	.008	.203	.008	.203	0.22	0.10
S048N063	3/64	1.19	7x7	1/16	1.59	.010	.254	.008	.203	0.49	0.22
S064N094	1/16	1.59	7x7	3/32	2.38	.012	.305	.016	.406	0.93	0.42
S064N125	1/16	1.59	7x7	1/8	3.18	.014	.356	.031	.787	1.18	0.53
S065N094	1/16	1.59	7x19	3/32	2.38	.012	.305	.016	.406	0.93	0.42
S065N125	1/16	1.59	7x19	1/8	3.18	.014	.356	.031	.787	1.18	0.53
S094N125	3/32	2.38	7x7	1/8	3.18	.014	.356	.016	.406	1.85	0.84
S094N156	3/32	2.38	7x7	5/32	3.97	.016	.406	.031	.787	2.18	0.99
S095N125	3/32	2.38	7x19	1/8	3.18	.014	.356	.016	.406	1.99	0.90
S095N156	3/32	2.38	7x19	5/32	3.97	.016	.406	.031	.787	2.32	1.05
S126N188	1/8	3.18	7x19	3/16	4.76	.018	.457	.031	.787	3.62	1.64
S158N218	5/32	3.97	7x19	7/32	5.56	.018	.457	.031	.787	6.10	2.77
S188N250	3/16	4.76	7x19	1/4	6.35	.018	.457	.031	.787	7.75	3.51
S252N313	1/4	6.35	7x19	5/16	7.94	.020	.508	.031	.787	12.30	5.58
S315N438	5/16	7.94	7x19	7/16	11.11	.024	.610	.063	1.60	19.80	8.98
S375N500	3/8	9.53	7x19	1/2	12.7	.027	.686	.063	1.60	27.20	12.34

TYPE I NON-JACKETED WIRE ROPE

MIL-DTL-83420,
LATEST AMENDMENT
COMPOSITION A,
CARBON STEEL,
TIN OR ZINC COATED

SAVA Part No.	Nominal Cable Dia.		Construction	Tolerance on Diameter (Plus Only)		Allowable Increase of Dia. at Cut End		Minimum Breaking Strength Composition A		Approximate Weight per 100 Feet	
	in.	mm		in.	mm	in.	mm	lbs.	kg	lbs.	kg
G030	1/32	.79	3x7	.006	.152	.006	.152	110	50	0.16	0.07
G048	3/64	1.19	7x7	.008	.203	.008	.203	270	122	0.42	0.19
G064	1/16	1.59	7x7	.010	.254	.009	.229	480	218	0.75	0.34
G065	1/16	1.59	7x19	.010	.254	.009	.229	480	218	0.75	0.34
G094	3/32	2.38	7x7	.012	.305	.010	.254	920	418	1.60	0.72
G095	3/32	2.38	7x19	.012	.305	.010	.254	1,000	453	1.74	0.79
G126	1/8	3.18	7x19	.014	.356	.011	.279	2,000	907	2.90	1.31
G158	5/32	3.97	7x19	.016	.406	.017	.432	2,800	1270	4.50	2.04
G188	3/16	4.76	7x19	.018	.457	.019	.483	4,200	1905	6.50	2.95
G252	1/4	6.35	7x19	.018	.457	.021	.533	7,000	3175	11.00	4.99
G315	5/16	7.94	7x19	.022	.559	.024	.610	9,800	4445	17.30	7.85
G375	3/8	9.53	7x19	.026	.660	.027	.686	14,400	6532	24.30	11.00

TYPE II JACKETED WIRE ROPE

MIL-DTL-83420,
LATEST AMENDMENT
COMPOSITION A,
CARBON STEEL
TIN OR ZINC COATED
WITH NYLON JACKET

SAVA Part No.	Nominal Cable Dia.		Construction	Outside Diameter of Jacket		Tolerance on Jacket O.D. (Plus Only)		Jacket Wall Thickness (Reference)		Approximate Weight per 100 Feet	
	in.	mm		in.	mm	in.	mm	in.	mm	lbs.	kg
G030N047	1/32	.79	3x7	3/64	1.19	.008	.203	.008	.203	0.22	0.10
G048N063	3/64	1.19	7x7	1/16	1.59	.010	.254	.008	.203	0.49	0.22
G064N094	1/16	1.59	7x7	3/32	2.38	.012	.305	.016	.406	0.93	0.42
G064N125	1/16	1.59	7x7	1/8	3.18	.014	.356	.031	.787	1.18	0.53
G065N094	1/16	1.59	7x19	3/32	2.38	.012	.305	.016	.406	0.93	0.42
G065N125	1/16	1.59	7x19	1/8	3.18	.014	.356	.031	.787	1.18	0.53
G094N125	3/32	2.38	7x7	1/8	3.18	.014	.356	.016	.406	1.85	0.84
G094N156	3/32	2.38	7x7	5/32	3.97	.016	.406	.031	.787	2.18	0.99
G095N125	3/32	2.38	7x19	1/8	3.18	.014	.356	.016	.406	1.99	0.90
G095N156	3/32	2.38	7x19	5/32	3.97	.016	.406	.031	.787	2.32	1.05
G126N188	1/8	3.18	7x19	3/16	4.76	.018	.457	.031	.787	3.62	1.64
G158N218	5/32	3.97	7x19	7/32	5.56	.018	.457	.031	.787	6.10	2.77
G188N250	3/16	4.76	7x19	1/4	6.35	.018	.457	.031	.787	7.75	3.51
G252N313	1/4	6.35	7x19	5/16	7.94	.020	.508	.031	.787	12.30	5.58
G315N438	5/16	7.94	7x19	7/16	11.11	.024	.610	.063	1.60	19.80	8.98
G375N500	3/8	9.53	7x19	1/2	12.7	.027	.686	.063	1.60	27.20	12.34

MS-20663 BALL AND DOUBLE SHANK

MS PART NO. STAINLESS STEEL	FOR CABLE DIA.	As DIA.	REF.	Bs SPHERICAL DIA.	±	Ls APPROX.	Rs MAX RAD.
MS-20663-C1*	1/32 - 3/64	.075	REF.	.125	± .003	.180	.012
MS-20663-C2	1/16	.112	+ .000 - .003	.190	+ .000 - .003	.390	.014
MS-20663-C3	3/32	.143		.253		.578	.019
MS-20663-C4	1/8	.190		.315		.765	.023
MS-20663-C5	5/32	.222	+ .000 - .004	.379	+ .000 - .004	.953	.028
MS-20663-C6	3/16	.255	+ .000 - .005	.442	+ .000 - .005	1.140	.033
MS-20663-C7	7/32	.302		.505		1.328	.038
MS-20663-C8	1/4	.348		.567		1.515	.042
MS-20663-C9	9/32	.382	+ .000	.632	+ .000	1.719	.046
MS-20663-C10	5/16	.413	- .007	.694	- .007	1.875	.046

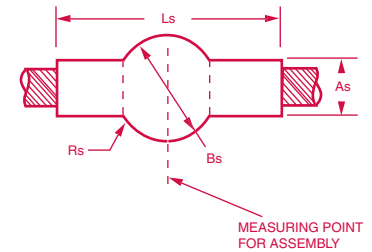

NOTES: *SAVA's P/N MS-20663-C1 has no applicable military specification.
All measurements in inches. Dimensions shown are after swaging.
Unless otherwise specified, decimal tolerances are ± .010.
STRENGTH: Generates full rated breaking strength of wire rope.
USAGE: Swaged to wire rope at ends or in center as control point.

MS-20664 SINGLE BALL AND SHANK

See page 14.

MS-20667 FORK

MS PART NO. STAINLESS STEEL	FOR CABLE DIA.	As DIA.	D DIA.		F + .010 - .005	G ± .003	H	LS APPROX.	U DIA.
MS-20667-2	1/16	.138	.190		.218	.093	.500	1.75	.344
MS-20667-3	3/32	.190			.254	.108	.670	2.06	.438
MS-20667-4	1/8	.219	.250	+ .000	.383	.195	.735	2.61	.547
MS-20667-5	5/32	.250			.406	.202	.800	3.00	.688
MS-20667-6	3/16	.313	.313	+ .002 - .000	.543	.260	.880	3.24	.781
MS-20667-7	7/32	.375			.625	.296	.970	3.74	.906
MS-20667-8	1/4	.438	.375	- .007	.688	.313	1.070	4.10	.969
MS-20667-9	9/32	.500			.719	.327	1.170	4.48	1.156
MS-20667-10	5/16	.563	.438	+ .000 - .008	.765	.348	1.268	4.86	1.265
MS-20667-12	3/8	.625			.500	+ .005 - .000	.830	.380	1.525

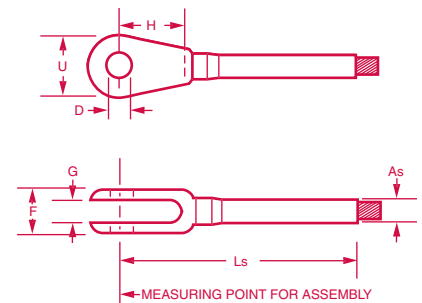

NOTES: All measurements in inches. Dimensions shown are after swaging.
Unless otherwise specified, decimal tolerances are ± .010.
STRENGTH: Generates full rated breaking strength of wire rope.

MS-20668 EYE

MS PART NO. STAINLESS STEEL	FOR CABLE DIA.	As DIA.	C ± .020	D DIA.		J	LS APPROX.	U + .025 - .010 DIA.
MS-20668-2	1/16	.138	.523	.190		.088	1.809	.359
MS-20668-3	3/32	.190				.707	.103	2.160
MS-20668-4	1/8	.219	.738			.190	2.593	.500
MS-20668-5	5/32	.250				.831	.250	.197
MS-20668-6	3/16	.313	.903	.313	+ .002 - .000	.255	3.187	.781
MS-20668-7	7/32	.375				1.007	.291	3.678
MS-20668-8	1/4	.438	1.133	.375		.307	4.062	.968
MS-20668-9	9/32	.500				1.257	.438	.322
MS-20668-10	5/16	.563	1.373		+ .000 - .008	.343	4.969	1.218
MS-20668-12	3/8	.625				1.688	.500	.375

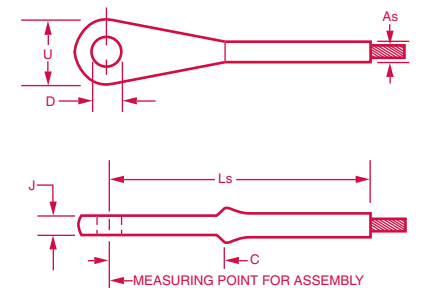

NOTES: All measurements in inches. Dimensions shown are after swaging.
Unless otherwise specified, decimal tolerances are ± .010.
STRENGTH: Generates full rated breaking strength of wire rope.

MS-21259 THREADED TERMINALS

MS PART NO. STAINLESS STEEL		FOR CABLE DIA.	THREAD B* NF-3A UNF-3A	As DIA.	D REF.	E REF.	Ls APPROX.	R + .005 - .000 DIA.	U DIA.	Y + .063 - .000
LH THREAD	RH THREAD									
MS-21259-2-LH	MS-21259-2-RH	1/16	# 6-40	.138	.188	.156	2.65	.063	.094	1.045
MS-21259-3-LH	MS-21259-3-RH	3/32	#10-32	.190						.250
MS-21259-4-LH	MS-21259-4-RH	1/8	1/4-28	.219	.313	.250	3.59	.063	.094	1.376
MS-21259-5-LH	MS-21259-5-RH	5/32		.250						- .005
MS-21259-6-LH	MS-21259-6-RH	3/16	5/16-24	.313	.375	.312	4.17	.098	.125	1.453
MS-21259-7-LH	MS-21259-7-RH	7/32	3/8-24	.375	.438	.375	4.81			1.625
MS-21259-8-LH	MS-21259-8-RH	1/4		.438	- .007	.500	.438	5.24	1.750	
MS-21259-9-LH	MS-21259-9-RH	9/32	7/16-20	.500	.625	.563	5.75	.098	.125	1.875
MS-21259-10-LH	MS-21259-10-RH	5/16	1/2-20	.563	.688	.625	6.27			2.000
MS-21259-12-LH	MS-21259-12-RH	3/8	9/16-18	.625	.750	.688	7.06	.098	.125	2.250

NOTES: All measurements in inches. Dimensions shown are after swaging.
Unless otherwise specified, decimal tolerances are $\pm .010$.
STRENGTH: Generates full rated breaking strength of wire rope.
*THREADS: Right-hand (RH) and left-hand (LH) threads available;
unless otherwise specified, right-hand threads will be furnished.
These terminals **are not** to be used with turnbuckle barrels.

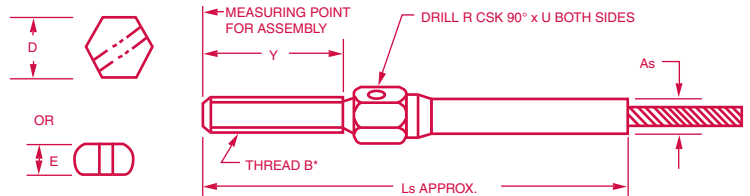

MS-21260 THREADED TERMINALS

MS PART NO. STAINLESS STEEL		FOR CABLE DIA.	THREAD B* NF-3A UNF-3A	As DIA.	C + .006 - .000 DIA.	D REF.	E REF.	F REF.	Ls APPROX.	R + .005 - .000 DIA.	U DIA.	Y $\pm .047$
LH THREAD	RH THREAD											
MS-21260-L2-LH	MS-21260-L2-RH	1/16	# 6-40	.138	.092	.188	.156	2.172	3.67	.063	.094	.375
MS-21260-S2-LH	MS-21260-S2-RH							1.297	2.79			
MS-21260-L3-LH	MS-21260-L3-RH	3/32	#10-32	.190	.133	.250	.187	2.157	3.86	.063	.094	.500
MS-21260-S3-LH	MS-21260-S3-RH							1.282	2.98			
MS-21260-L4-LH	MS-21260-L4-RH	1/8	1/4-28	.219	.195	.313	.250	2.157	4.28	.098	.125	.563
MS-21260-S4-LH	MS-21260-S4-RH			+ .000				1.282	3.40			
MS-21260-L5-LH	MS-21260-L5-RH	5/32	1/4-28	.250	.195	.313	.250	2.157	4.66	.098	.125	.625
MS-21260-S5-LH	MS-21260-S5-RH							- .005	1.282			
MS-21260-L6-LH	MS-21260-L6-RH	3/16	5/16-24	.313	.245	.375	.312	2.157	4.78	.098	.125	.750
MS-21260-S6-LH	MS-21260-S6-RH			+ .000				1.282	3.90			
MS-21260-7-LH	MS-21260-7-RH	7/32	3/8-24	.375	.306	.500	.438	2.157	5.21	.098	.125	.875
MS-21260-8-LH	MS-21260-8-RH	1/4		- .007				2.157	5.52			
MS-21260-9-LH	MS-21260-9-RH	9/32	7/16-20	.500	.361	.625	.563	2.157	5.90	.098	.125	1.000
MS-21260-10-LH	MS-21260-10-RH	5/16	1/2-20	.563	.406	.668	.625	2.157	6.30			
MS-21260-12-LH	MS-21260-12-RH	3/8	9/16-18	.625	.476	.750	.688	2.327	7.01	.098	.125	1.125

NOTES: All measurements in inches. Dimensions shown are after swaging.
Unless otherwise specified, decimal tolerances are $\pm .010$.
STRENGTH: Generates full rated breaking strength of wire rope.
*THREADS: Right-hand (RH) and left-hand (LH) threads available;
unless otherwise specified, right-hand threads will be furnished.
Normally used in conjunction with turnbuckle barrel MS-21251.
L and S designation refers to long and short shanks on threaded end.

